

SCALE 1:250
 0 2 4 6 8 10 20 METERS
 ALL DISTANCES AND ELEVATIONS ARE IN METERS.

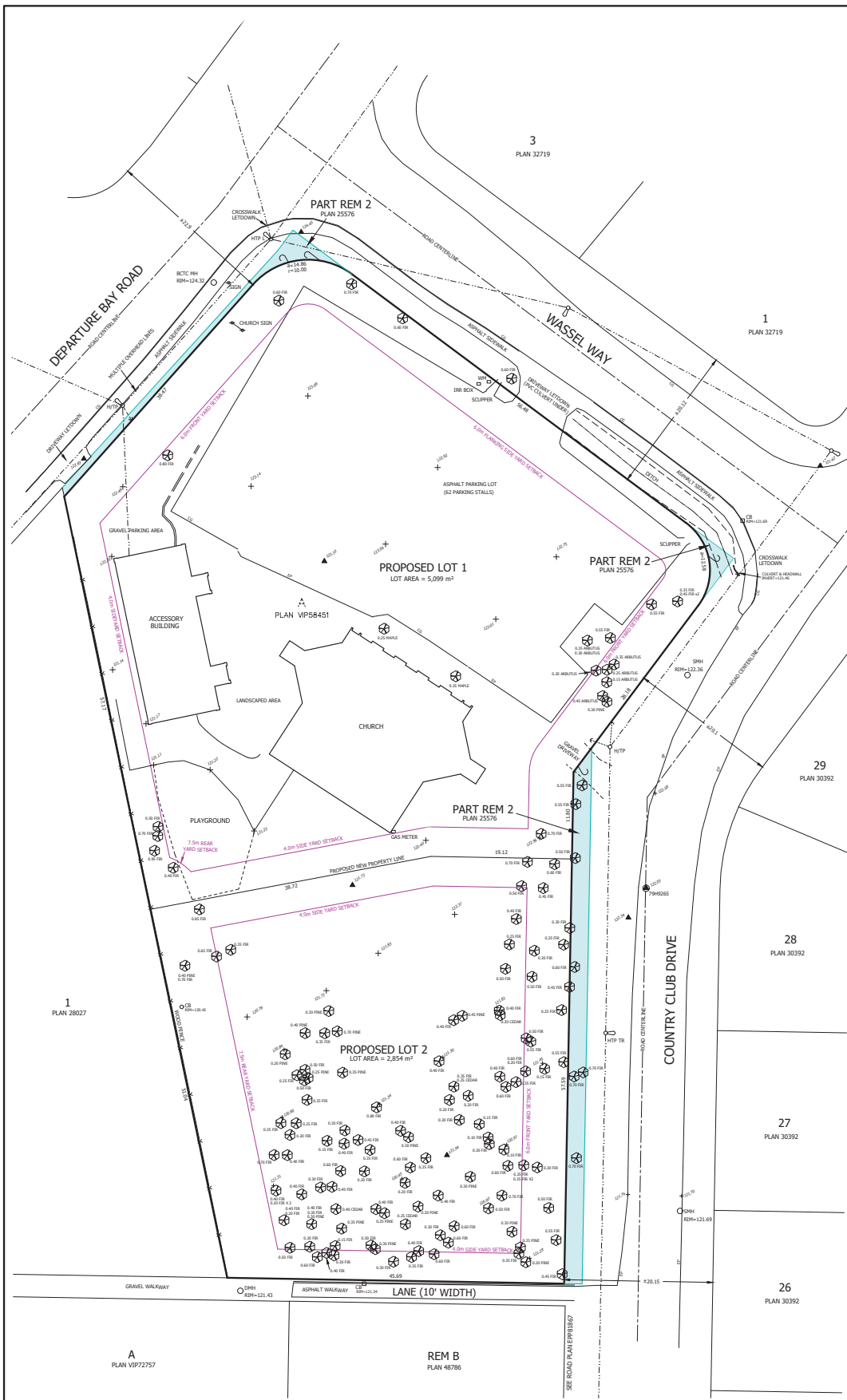

LEGEND

+ 222.40	SPOT ELEVATION
●	STANDARD CONTROL MONUMENT FOUND.
○	STANDARD BORN POINT FOUND.
●	SURVEY CONTROL POINT.
○	SANITARY SEWER MANHOLE.
○	DRAINAGE (STORM SEWER) MANHOLE.
□	CATCH BASIN.
—	DITCH LINE.
○	WATER METER.
○	HYDRANT AND TIE POLE.
—	POLE ANCHOR.
—	OVERHEAD HYDRO AND TIE LINE.
—	LAMP STANDARDS.
—	EDGE OF PAVEMENT.
—	CURB & GUTTER (GUTTER LINE).
■	BCFCA OWNED TITLED LANDS

GENERAL NOTES:
 DISTANCES AND ELEVATIONS ARE IN METERS. ELEVATIONS ARE GEODETIC REFERENCED TO CANADIAN GEODETIC VERTICAL DATUM 1928 (CGVD08) DERIVED FROM INTEGRATED SURVEY CONTROL MONUMENTS.
 THIS PLAN PURPORTS TO IDENTIFY ONLY THE ACTUAL AND / OR PROPOSED IMPROVEMENT(S) SHOWN RELATIVE TO ONLY THE BOUNDARIES SHOWN OF OR APPURTENANT TO THE SUBJECT PARCELS.
 THIS PLAN PROVIDES NO WARRANTY OR REPRESENTATION WHATSOEVER WITH RESPECT TO THE LOCATION OF ANY OTHER ACTUAL OR PROPOSED IMPROVEMENT(S) RELATIVE TO ANY BOUNDARY OF OR APPURTENANT TO THE SUBJECT PARCELS.

FIELD SURVEY COMPLETED JANUARY 21, 2025
 LOT ALIGNMENT DERIVED FROM FIELD SURVEY.
 THIS PARCEL MAY BE SUBJECT TO REGISTERED CHARGES & INTERESTS.
 PERMIT: F840705;
 THIS PLAN DOES NOT PURPORT TO VERIFY COMPLIANCE WITH THE RESTRICTIONS THEREIN.
 CITY OF NANAIMO ZONING: C33 (COMMUNITY SERVICE ONE)
 CITY OF NANAIMO ODP FUTURE LAND USE DESIGNATION: RESIDENTIAL CORRIDOR

NO.	DATE	REVISION
01	SEPTEMBER 25, 2025	FIRST ISSUE
02	NOVEMBER 21, 2025	UPDATE FOR PLA APPLICATION SUBMISSION

PROJECT: ST. ANDREWS PREBYTERIAN CHURCH
CIVIC: 4235 DEPARTURE BAY ROAD
LEGAL: LOT A, SECTION 5, WELLINGTON DISTRICT, PLAN VIP58451 (PID: 018-826-911)
CLIENT: CONSTRUCTIVE MANAGEMENT
DRAWING: PROPOSED SUBDIVISION LOT LAYOUT
SCALE: 1:250
DRAWN: CH
FILE: 24108-2 PLA **BASIS/PLAN:** 24108

WILLIAMSON & ASSOCIATES
 PROFESSIONAL SURVEYORS
 3088 BARKING ROAD, NANAIMO B.C. V1T 4B5
 PHONE: (250) 756-7723, EMAIL: WAM@WELLCA.CA